

iOS Corporate Device Enrolment

- 1) On your iOS device download and install the “Company Portal” app from the app store

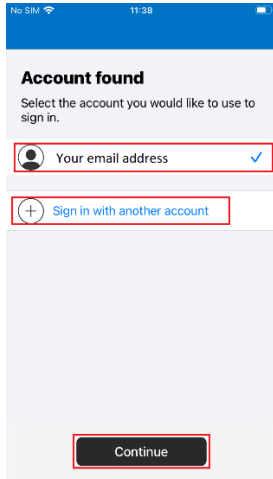

- 2) Open the Company Portal app and sign in with your email address and password and click “continue” (your email address may show up already – tap it to sign in)



- 3) Once signed in It will ask you to set up company access. Click “Begin”.

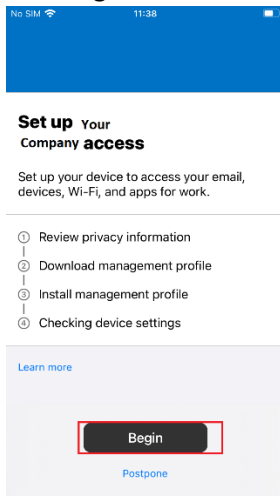

- 4) Review the privacy information and tap continue

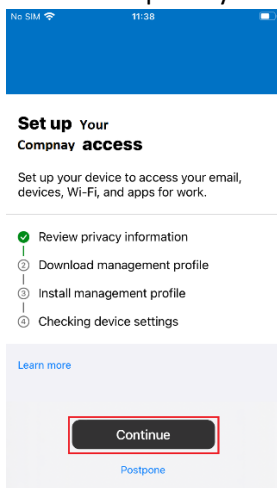

- 5) Tap “Allow” to start the process to download the management profile

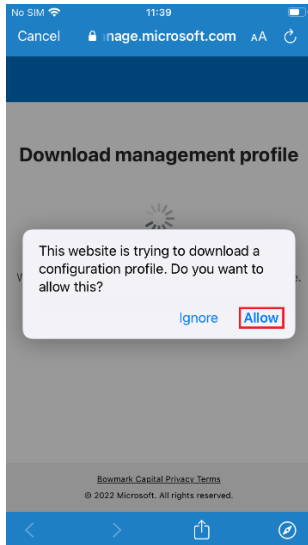

- 6) Tap “Continue”

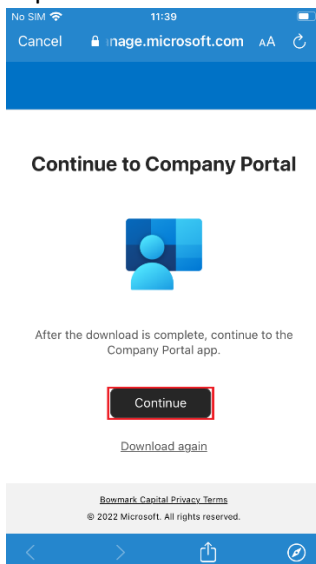

- 7) Once you reach the “How to install management profile” page, go back to your home screen and open the “Settings” app then tap “General”

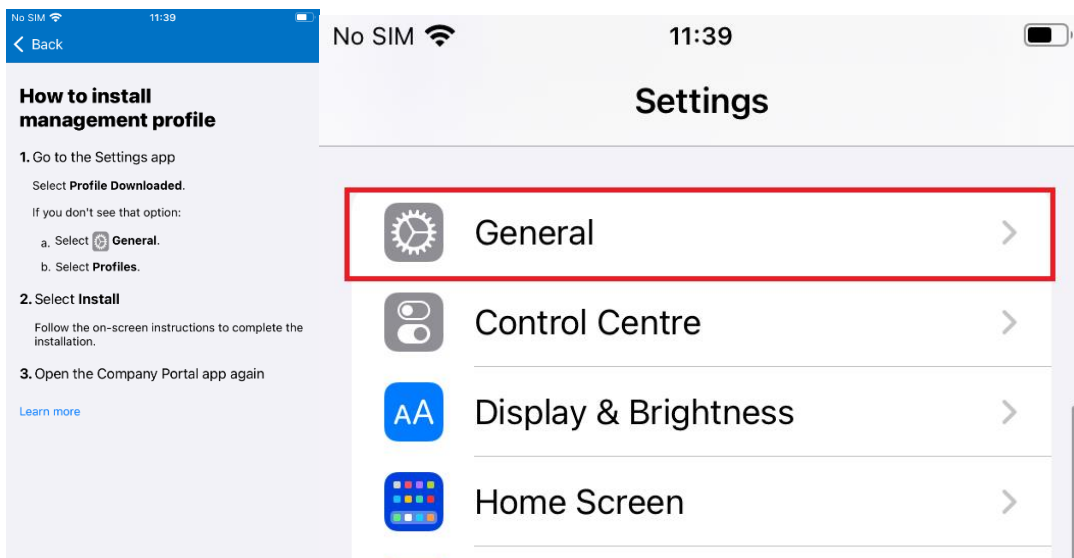

8) Tap “VPN and Profile Management”



9) Tap Management Profile



10) Tap “Install”

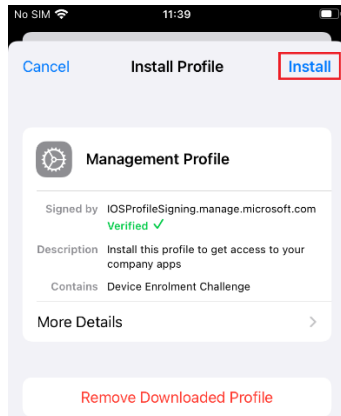

11) Tap “Install”

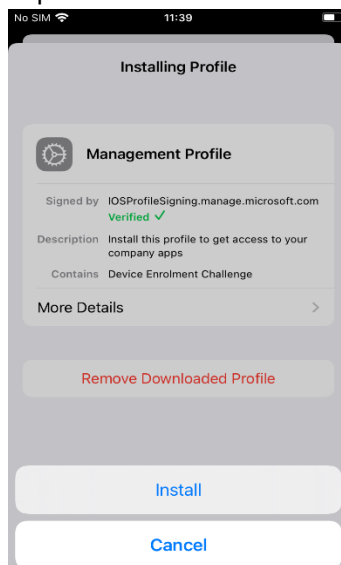

12) Tap "Install"

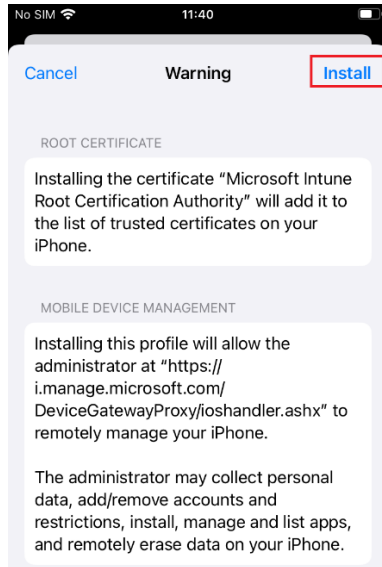

13) Tap "Trust" for the remote management profile

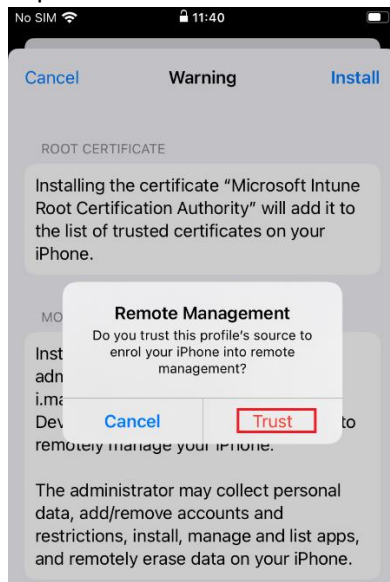

14) If the previous steps are successful, you will see that the management profile has installed.

Tap "done"

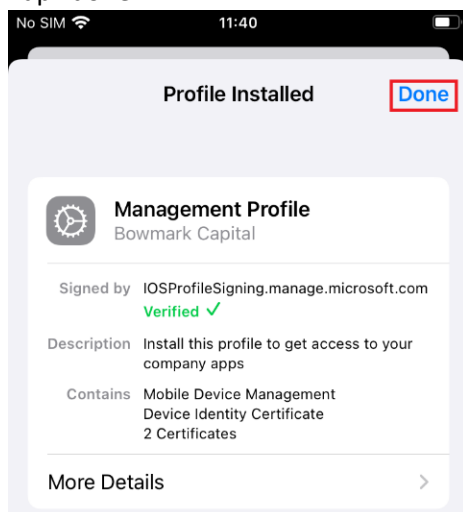

- 15) Open the Company Portal App again and confirm that the “Install management profile” step is ticked. Tap “Continue”

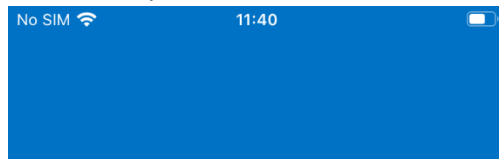

Set up Your Company access

Set up your device to access your email, devices, Wi-Fi, and apps for work.

- ✓ Review privacy information
- ✓ Download management profile
- ✓ Install management profile
- ④ Checking device settings

[Learn more](#)

Continue

[Postpone](#)

- 16) You will likely get multiple prompts that your company wants to take management of Microsoft Apps (Like Outlook, Office etc). Tap “Manage” on each of these prompts



- 17) If there are any apps being pushed by your company that are not already installed, you will be prompted to install them. Tap “Install” as these notifications appear.

